



**4027—
2013**

**ISO 4027:2003
Hexagon socket set screws with cone point
(IDT)**



2014

Hexagon socket set screws with cone point

— 2015—01—01

1

1,6 24
 898-5, 965-2, 3506-3 4759-1. 261,

2

(ISO 225, Fasteners — Bolts, screws, studs and nuts — Symbols and designations of dimensions)
 225
 261 ISO (ISO 261, ISO general-purpose metric screw threads — General plan)
 898-5
 5. (ISO 898-5. Mechanical properties of fasteners made of carbon steel and alloy steel — Part 5: Set screws and similar threaded fasteners not under tensile stresses)
 965-2 ISO 2. (ISO 965-2, ISO general purpose metric screw threads — Tolerances — Part 2: Limits of sizes for general purpose external and internal screw threads — Medium quality)
 965-3 ISO 3. (ISO 965-3, ISO general purpose metric screw threads — Tolerances — Part 3: Deviations for constructional screw threads)
 3269 (ISO 3269, Fasteners—Acceptance inspection)
 3506-3
 3. (ISO 3506-3, Mechanical properties of corrosion-resistant stainless-steel fasteners — Part 3: Set screws and similar fasteners not under tensile stress)
 4042 (ISO 4042, Fasteners — Electroplated coatings)
 4759-1 1. (ISO 4759-1, Tolerances for fasteners — Part 1: Bolts, screws, studs and nuts — Product grades A, and C)
 6157-1 1. (ISO 6157-1, Fasteners — Surface discontinuities — Part 1: Bolts, screws and studs for general requirements)

- 8839 (ISO 8839. Mechanical properties of fasteners — Bolts, screws, studs and nuts made of non-ferrous metals)
- 8992 (ISO 8992, Fasteners — General requirements for bolts, screws, studs and nuts)
- 10683 (ISO 10683, Fasteners — Non-electrolytically applied zinc flake coatings)
- 23429 (ISO 23429, Gauging of hexagon sockets)

3

1 1.
225

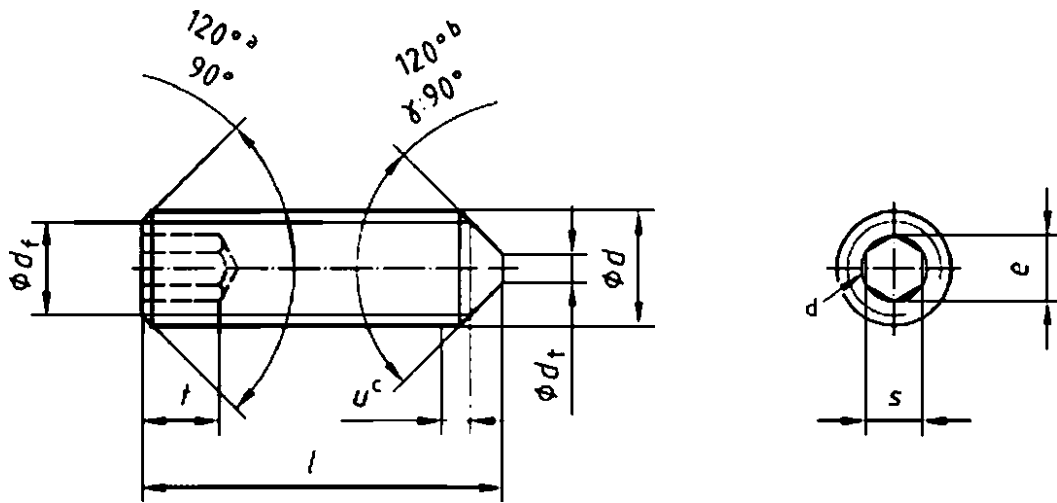

J^k

1/3
/2.

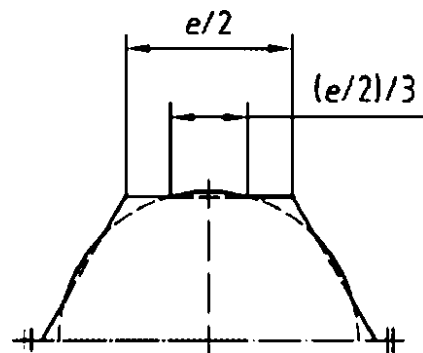

120° —
1.

<2

1 90

120*

1

	(1.6	2	M2.S	3	4	5				12	16	N20	24
	*		0.35	0.4	0.45	0.5	0.7	0.8	1	1.25	1.5	1.75	2	2.5	3
	»		04	0,5	0.65	0.75	1	1.25	1,5	2	2,5	3	4	5	6
	4		*												
			0.809	1.011	1.454	1.733	2.303	2.873	3.443	4.583	5,723	6.863	9.149	11.429	13.716
			0.7	0.9	1.3	1.5	2	2.5	3	4	5		8	10	12
\$«			0.724	0.913	1.300	1.58	2.08	2.58	3.08	4.095	5.14	6.14	8.175	10.175	12.212
			0.710	0.887	1.275	1.52	2.02	2.52	3.02	4.020	5.02	6.02	8.025	10.025	12.032
t		cf	0.7	0.8	1.2	1.2	1.5	2	2	3	4	4.8	64	8	10
			1.5	1.7	2	2	2,5	3	3,5	5	6	8	10	12	1S
	1		1000 (* 7.65 / *)												
			(,)												
2	1.5	2.2		*											
2.5	2.3	2.7	0.025	0,037	0.063										
3	2.5	3.2	0.029	0 044	0.075	0.09									
4	3.76	4.24	0.037	0.059	0.1	0.13									
5	4 76	5.24	0.046	0.074	0.12S	0.17	028	A.W 1							
6	5.76	6.24	0.054	0.089	0.15	0.21	0.34	0.49 j ®							
	7.71	6.29	0.07	0.119	0.199	0.29	0.5	0.73	104						
10	9.71	10.29		0.146	0.249	0.37	0.66	0.97	1.39	2.35	^,41				
12	11.65	12.35			0.299	0.45	0.82	1.21	1.74	2.98	4.42	-6.1 1			
16	15.65	16.35				0.61	1.14	1.69	2.44	424	6.43	8.9	»		
20	19.58	20.42					1.46	2.17	3.14	5.5	6.44	11.7	20.1		
25	24.56	2542						2.77	402	7.08	10.9	15.3	26.6		
30	29.58	30.42							4.89	8.65	13.5	18.8	33.1	51	68.7
35	345	355								10.2	16	22.3	39.6	61.3	83.2
40	39.5	40.5								11.8	18.5	25.6	46.1	71.6	97.7
45	44 5	45 5									21	29.3	52.6	81 9	112
50	49.5	50.5									23.5	32.8	59.1	92.2	127
55	544	556										383	65.6	103	141
60	59.4	60.6										39.8	72.2	113	156

« —
 $b_{e_{fuvIT}} = 1.14^* *$

s 23429

4
 *

4

2.

2—

			-	
		8992		
		6		
		261. 965-2. ISO 965-3		
		45	1-12 , 2-21 , - 21 , 4-21 , 5-21	
		898-5	3506-3	8839
		4759-1		
		4042		4042
		10683		
		6157-1		
		3269		

5

1 = 12

4SH

4027 — 12—45 .

4027—2013

621.882.219.76

21.060.

32

165000

:

,

,

,

-

01.04 2014

60x84%.

. . . 0.93.

31

. . 910.

,

<

>

123995

.

.. 4.

wwAv.gostinfo.ru info@gostinfo.ru